



RP-IPJ811-60W

60W Industrial Gigabit PoE+ Injector

The RP-IPJ811-60W a high power single port Industrial POE Injector provides PoE power budget up to 60W. The device supports 10/100/1000Mbps data transmission and is powered with 48-56 Volts DC.

The built-in 4 pin DIP switches are able to select POE for Mode A or Mode B, to select standard IEEE802.3at 30Watts or high power 36Watts, and to select 2 pair or 4 pair for 30/36Watts or 60/72Watts power output. This is possible through the use of all four pairs of twisted-pair cables.

RP-IPJ811-60W is well suited for applications in deploying IP surveillance, traffic monitoring and for a broad range of applications. It is being rigorously tested for your Security, Transportation and Telco application in climatically demanding environments with wide temperature range from -40 to 75°C. With IP30 industrial case protection, the device provides a high level of immunity against corrosion and electromagnetic interference. RP-IPJ811-60W also allows either DIN rail or wall mounting for efficient use of cabinet.

Features

- One port 10/100/1000 Base-T (Data) for connection to the Ethernet Switch
- One port 10/100/1000 Base-T PoE (Power/Data) for connection to the PoE device (PD)
- Built-in hardened POE Controller
- Selectable Mode A End-Span or Mode B Mid-Span
- Selectable power output for 30W or 60W
- Selectable Mode for standard POE or ultra POE
- Deliver ultra high power up to 60Watts
- Maximum POE power 72watts at 48VDC input
- Support redundant power
- Reverse polarity protection
- Overload current protection
- IP30 Rugged Aluminum housing design
- Working in extreme environment -40 to +75°C

Specifications

| | |
|------------------------------------|--|
| Standards | <ul style="list-style-type: none"> • IEEE 802.3 10Base-T Ethernet • IEEE 802.3u 100Base-TX Fast Ethernet • IEEE 802.3ab 1000Base-T Gigabit Ethernet • IEEE802.3af for POE • IEEE802.3at for POE+ |
| Interface | <ul style="list-style-type: none"> • 1 x RJ-45 10/100/1000BaseT(X) Data • 1 x RJ-45 10/100/1000BaseT(X) PSE Output power |
| Network Cable | <ul style="list-style-type: none"> • UTP/STP above Cat.5e Cable, EIA/TIA-568 10-ohm (100m) |
| Protocol | <ul style="list-style-type: none"> • CSMA/CD |
| LED Indicators | <ul style="list-style-type: none"> • PW1 (Green): ON – Power is detected • PW2 (Green): ON – Power is detected • Mode A (Green): ON – End Span PD detected • Mode B (Green): ON – Mid Span PD detected • 4 Pair (Amber): ON – 60W PSE is in active mode OFF – 30W PSE is in active mode |
| POE Pin Assignment | <ul style="list-style-type: none"> • Mode A (End-Span): V+, V+, V-, V- for pin 1, 2, 3, 6 (Default) • Mode B (Mid-Span): V+, V+, V-, V- for pin 4, 5, 7, 8 |
| DIP Switch | <ul style="list-style-type: none"> • DIP1: ON – 4 pair (60/72Watts) (default) OFF – 2 pair (30/36Watts) • DIP2: ON – Mode B Mid-Span OFF – Mode A End-Span (default) • DIP3: ON – IEEE802.3at 30W OFF – High power 36W (default) • DIP4: Reserved |
| Reverse polarity protection | <ul style="list-style-type: none"> • Present |
| Overload current protection | <ul style="list-style-type: none"> • Present |
| Power Consumption | <ul style="list-style-type: none"> • 1 W@48 VDC full load, Without POE |
| Power Supply | <ul style="list-style-type: none"> • Redundant power source, 48-56VDC Power Input |
| POE power | <ul style="list-style-type: none"> • Maximum POE power 72watts at 48VDC input |
| Removable Terminal Block | <ul style="list-style-type: none"> • Provide 4 pin terminal block • Wire range: 0.34mm² to 2.5mm² • Solid wire (AWG):12-24/14-22 • Stranded wire(AWG): 12-24/14-22 • Torque:5lb-In/0.5Nm/0.56Nm • Wire Strip length: 7-8mm |
| Environment | <ul style="list-style-type: none"> • Operating temperature : -40°C~75°C • Storage temperature: -40°C ~85°C • Operating Humidity: 5% to 95% (Non-Condensing) |
| Dimension | <ul style="list-style-type: none"> • 103.5 x 32 x 81.5 mm (LxWxD) |
| Housing | <ul style="list-style-type: none"> • Rugged Aluminum, IP30 Protection |
| Installation | <ul style="list-style-type: none"> • DIN Rail and Wall Mount Design |
| EMC/EMS | <ul style="list-style-type: none"> • CE, FCC |
| EMI | <ul style="list-style-type: none"> • FCC Part 15 Subpart B Class A, CE EN 55022 Class A |
| Safety | <ul style="list-style-type: none"> • IEC EN60950-1 |

Application

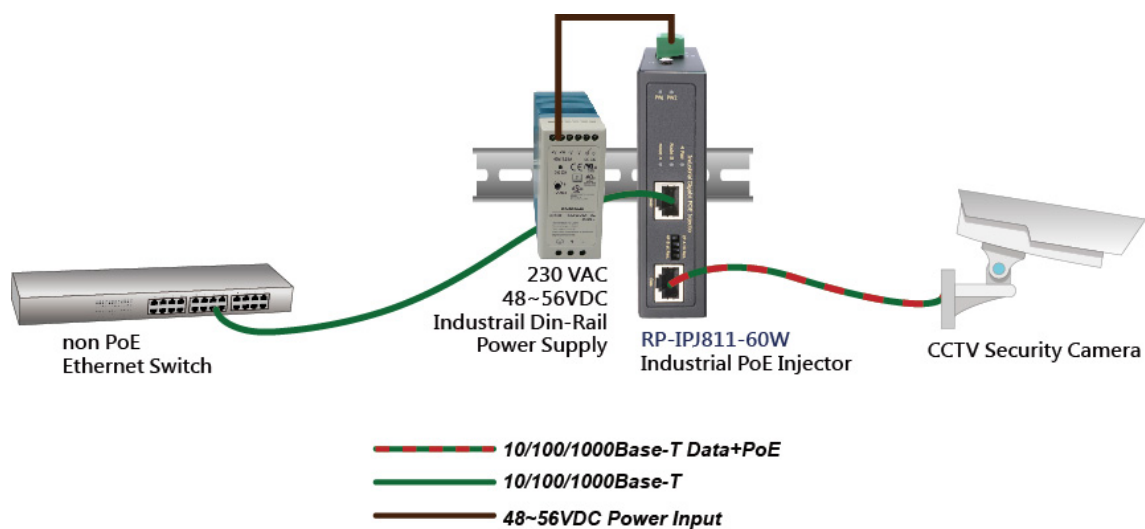

Dimension

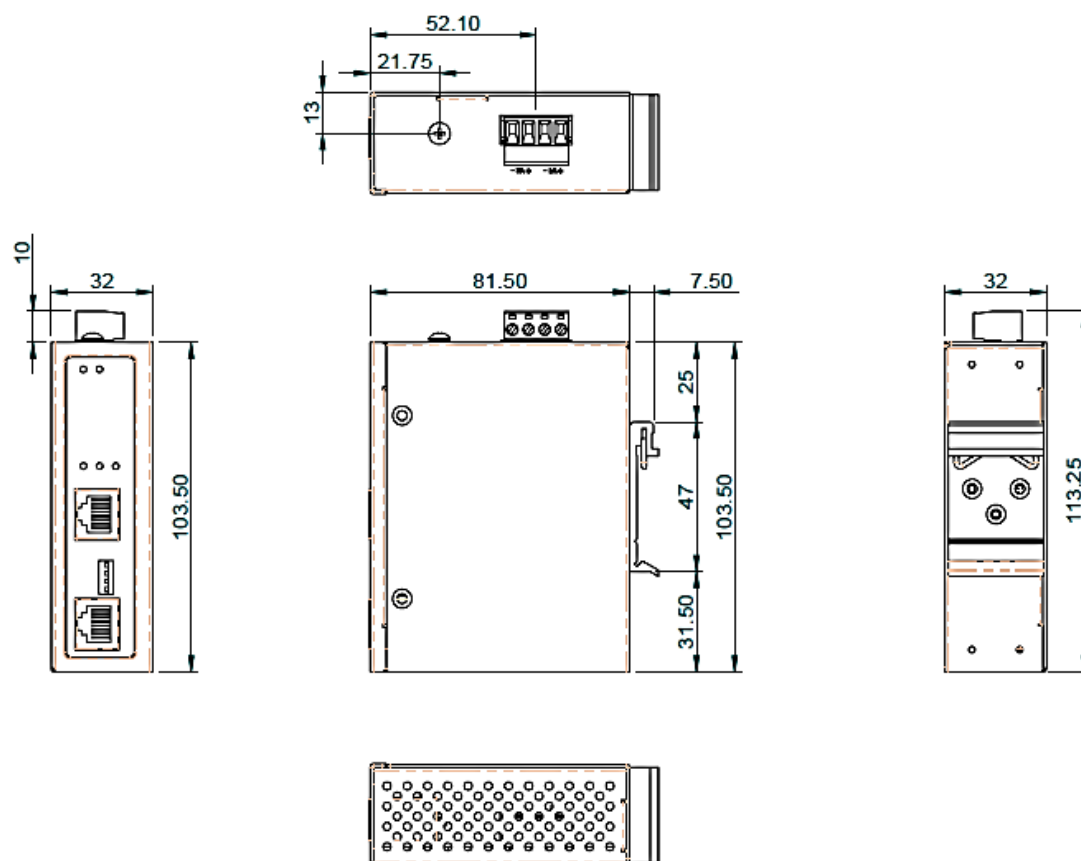

Ordering information

RP-IPJ811-60W 60W Industrial Gigabit PoE+ Injector, 48-56VDC